

## Cap

3000# 6000# 9000#

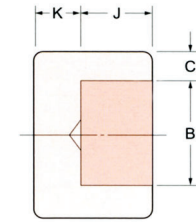

ANSI B16.11

Nom Pipe Size	Socket Bore Dia	Socket Wall Thickness C(Ave/Min)		
		B	3000	6000
1/8	10.8 11.2	3.18/3.18	3.96/3.43	-
1/4	14.2 14.6	3.78/3.30	4.60/4.01	-
3/8	17.6 18.0	4.01/3.50	5.03/4.37	-
1/2	21.8 22.2	4.67/4.09	5.97/5.18	9.35/8.18
3/4	27.2 27.6	4.90/4.27	6.96/6.04	9.78/8.56
1	33.9 34.3	5.69/4.98	7.92/6.93	11.38/9.96
1 1/4	42.7 43.1	6.07/5.28	7.92/6.96	12.14/10.62
1 1/2	48.8 49.2	6.35/5.54	8.92/7.80	12.70/11.12
2	61.2 61.7	6.93/6.04	10.92/9.50	13.84/12.12
2 1/2	73.9 74.4	8.67/7.67	-	-
3	89.8 90.3	9.52/8.30	-	-
4	115.2 115.7	10.69/9.35	-	-

(Unit : mm)

Depth Min J	Socket Wall Thickness K(Min)		
	3000	6000	9000
9.5	4.8	6.4	-
9.5	4.8	6.4	-
9.5	4.8	6.4	-
9.5	6.4	7.9	11.2
12.5	6.4	7.9	12.7
12.5	9.6	11.2	14.2
12.5	9.6	11.2	14.2
12.5	11.2	12.7	15.7
16.0	12.7	15.7	19.0
16.0	15.7	19.0	-
16.0	19.0	22.4	-
19.0	22.4	28.4	-

- Dimensions are in millimeters.
- Average of socket wall thickness around periphery shall be no less than listed values. The minimum values are permitted in localized areas.

## Full Coupling Half Coupling, Cap

3000# 6000#

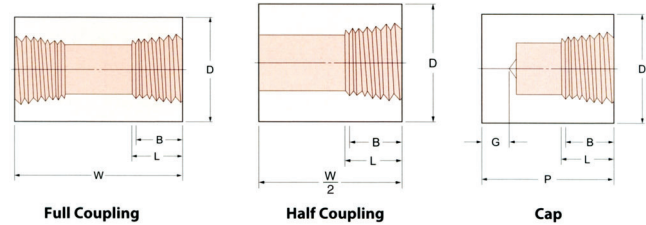

ANSI B16.11

(Unit : mm)

Nom Pipe Size	Outside Diameter D		Full Coupling End to End W
	3000	6000	
1/8	16	22	32
1/4	19	25	35
3/8	22	32	38
1/2	28	38	48
3/4	35	44	51
1	44	57	60
1 1/4	57	64	67
1 1/2	64	76	79
2	76	92	86
2 1/2	92	108	92
3	108	127	108
4	140	159	121

Cap				Length of thread Min(1)	
Ent to End P		Thickness Min G			
3000	6000	3000	6000	B	L
19	-	4.8	-	6.4	6.7
25	27	4.8	6.4	8.1	10.2
25	27	4.8	6.4	9.1	10.4
32	33	6.4	7.9	10.9	13.6
37	38	6.4	7.9	12.7	13.9
41	43	9.7	11.2	14.7	17.3
44	46	9.7	11.2	17.0	18.0
44	48	11.2	12.7	17.8	18.4
48	51	12.7	15.7	19.0	19.2
60	64	15.7	19.0	23.6	28.9
65	68	19.0	22.4	25.9	30.5
68	75	22.4	28.4	27.7	33.0

• Dimensions B is minimum length of perfect thread. The length of useful thread(L plus threads with fully formed roots and crests) shall not be less than L(effective length of external thread) required by American National Standard for Pipe Threads(ASME B1.20.1)

\*Class 2000 and NPS 1/8 class 6000 couplings, half couplings, and caps are not included in this standard

## Plug Bushing

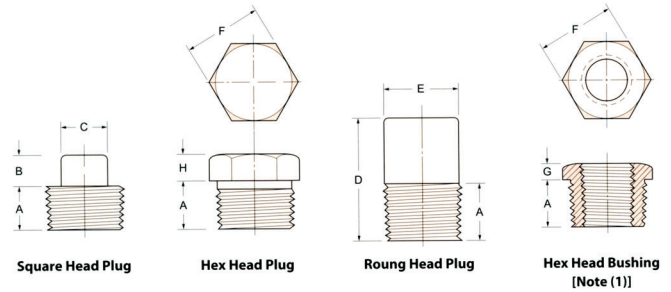

ANSI B16.11

Nom Pipe Size	Length (Min) A	Plugs Square Head	
		Height of Square(min) B	Width Flats(Min) C
1/8	10	6	7
1/4	11	6	10
3/8	13	8	11
1/2	14	10	14
3/4	16	11	16
1	19	13	21
1 1/4	21	14	24
1 1/2	21	16	28
2	22	18	32
2 1/2	27	19	36
3	28	21	41
4	32	25	65

(Unit : mm)

Plugs Round Head		Hex Plugs & Bushing		
Length (Min) D	Nominal Diameter of Head E	Width Flats (Nom) F	Hex Height Min	
			Bushing G	Plug H
35	10	11	-	6
41	14	16	3	6
41	18	18	4	8
44	21	22	5	8
44	27	27	6	10
51	33	36	6	10
51	43	46	7	14
51	48	50	8	16
64	60	65	9	18
70	73	75	10	19
70	89	90	10	21
76	114	115	13	25

- CAUTIONARY NOTE REGARDING HEX HEAD BUSHINGS. Hex HEAD Bushings of one-size reduction should not be used in services wherein they might be subject to harmful loads and forces other than internal pressures.